

# SKETCH/AREA TABLE ADDENDUM

## SUBJECT INFO

File No.: Parcel No.:  
 Property Address: 562 Bald Eagle Way  
 City: Loveland County: State: CO ZipCode: 80537  
 Owner:  
 Client: Catherine Rogers Client Address: catherine@live-noco.com  
 Measurer Name: Chris Ouellette Inspection Date: 04/15/2022

## SKETCH

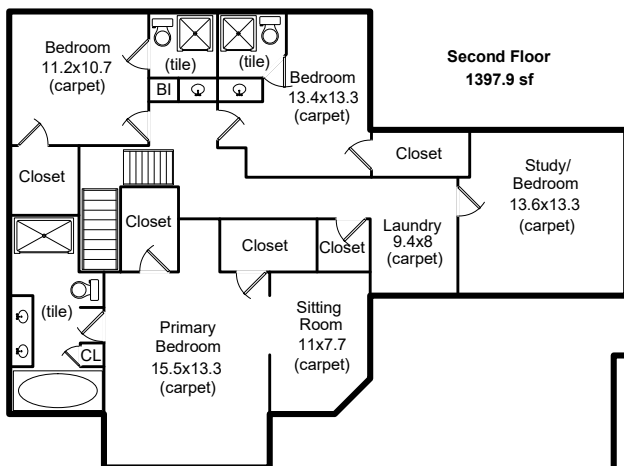
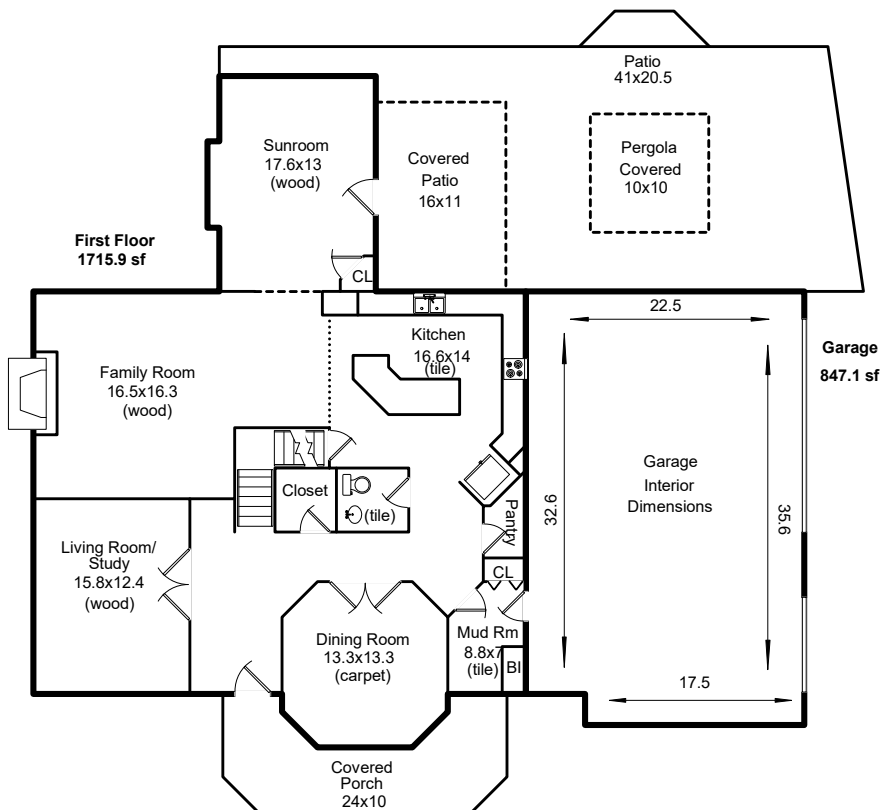

**562 Bald Eagle Way  
 Fort Collins, CO  
 Total Sq Ft: 4582  
 Total Finished Sq Ft: 3908  
 Finished w/o Basement: 3114  
 Basement Sq Ft: 1468  
 Basement Finish: 54%**

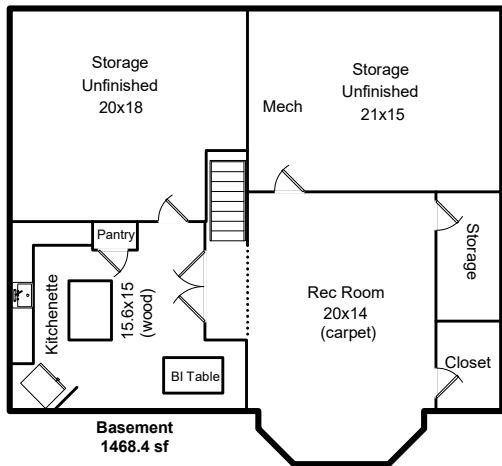
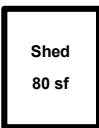

Scope of Work is on our Website  
[www.appraisaldimensions.com](http://www.appraisaldimensions.com)  
 04/15/2022  
 (c) Copyright

# SKETCH/AREA TABLE ADDENDUM

## SUBJECT INFO

File No.: Parcel No.:  
Property Address: 562 Bald Eagle Way  
City: Loveland County: State: CO ZipCode: 80537  
Owner:  
Client: Catherine Rogers Client Address: catherine@live-noco.com  
Measurer Name: Chris Ouellette Inspection Date: 04/15/2022

## SKETCH

### Garage (GAR)

36.60 x 18.50 = 677.10  
34.00 x 5.00 = 170.00  
Total area: 847.10

### First Floor (GLA1)

7.30 x 1.00 = 7.30  
18.20 x 13.20 = 240.24  
14.00 x 1.50 = 21.00  
8.00 x 3.00 = 24.00  
0.5 x 4.24 x 2.12 = 4.50  
0.5 x 4.24 x 2.12 = 4.50  
41.60 x 34.00 = 1414.40  
Total area: 1715.94

### Basement (BSMT)

14.00 x 1.50 = 21.00  
8.00 x 3.00 = 24.00  
0.5 x 4.24 x 2.12 = 4.50  
0.5 x 4.24 x 2.12 = 4.50  
41.60 x 34.00 = 1414.40  
Total area: 1468.40

### Second Floor (GLA2)

14.00 x 4.50 = 63.00  
21.60 x 14.00 = 302.40  
0.5 x 4.24 x 2.12 = 4.50  
27.50 x 3.00 = 82.50  
31.00 x 30.50 = 945.50  
Total area: 1397.90

### Shed (OTH)

10.00 x 8.00 = 80.00  
Total area: 80.00