

SKETCH/AREA TABLE ADDENDUM

SUBJECT INFO

| | | | |
|-----------------------------------|-----------------------------|-----------|----------------|
| File No.: | Parcel No.: | | |
| Property Address: 1806 Empire Ave | | | |
| City: Loveland | County: | State: CO | ZipCode: 80538 |
| Owner: | | | |
| Client: Catherine Rogers | Client Address: | | |
| Measurer Name: Chris Ouellette | Inspection Date: 03/23/2021 | | |

SKETCH

Scope of Work is on our Website
www.appraisaldimensions.com
 03/23/2021
 (c) Copyright

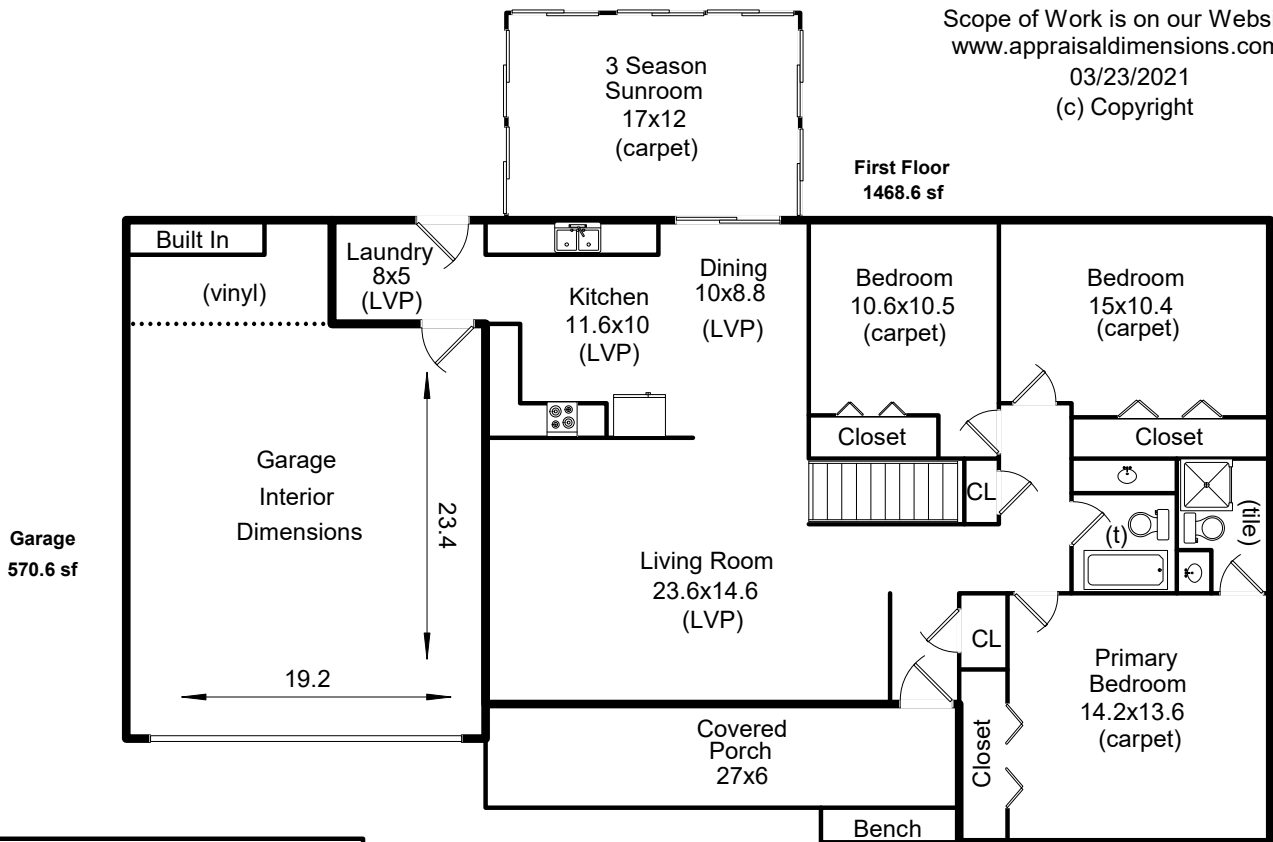

1806 Empire Ave
Loveland, CO
Total Sq Ft: 2740
Total Sq Ft w/Sunroom: 2944
Total Finished Sq Ft: 2740
First Floor w/ Sunroom: 1673
Finished w/o Basement: 1469
Basement Sq Ft: 1271
Basement Finish: 100%



Basement
1271.2 sf

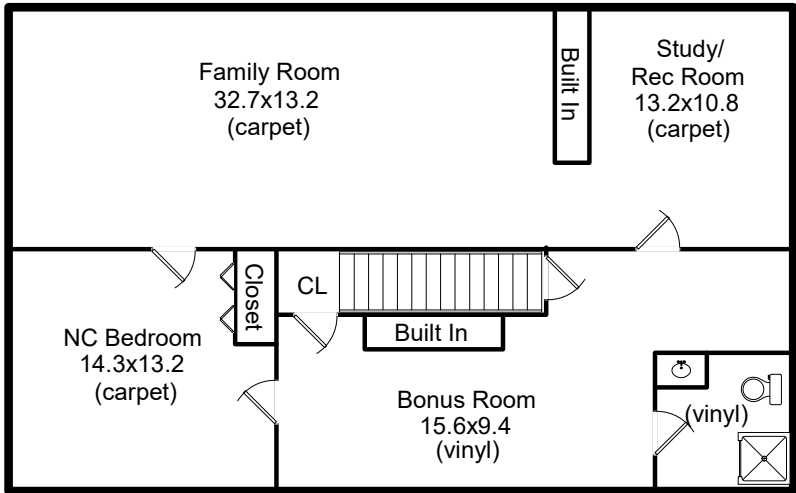

SKETCH/AREA TABLE ADDENDUM

SUBJECT INFO

File No.: Parcel No.:
Property Address: 1806 Empire Ave
City: Loveland County: State: CO ZipCode: 80538
Owner:
Client: Catherine Rogers Client Address:
Measurer Name: Chris Ouellette Inspection Date: 03/23/2021

SKETCH

Garage (GAR)

24.00 x 20.80 = 499.20
11.90 x 6.00 = 71.40
Total area: 570.60

First Floor (GLA1)

36.00 x 18.00 = 648.00
28.00 x 27.40 = 767.20
8.90 x 6.00 = 53.40
Total area: 1468.60

Basement (BSMT)

45.40 x 28.00 = 1271.20
Total area: 1271.20

Shed (OTH)

10.00 x 8.00 = 80.00
Total area: 80.00